

| REV | ECN | SIGN | DATE | DESCRIPTION |
|-----|-----|---------|------------|-------------|
| 1.0 | V0 | K. ZHAO | 05/22/2021 | |

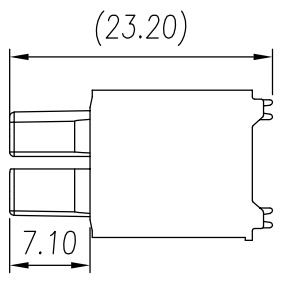
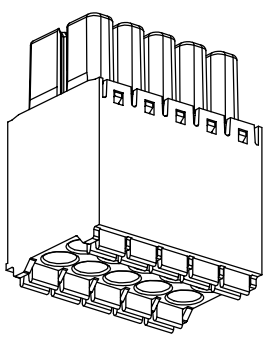
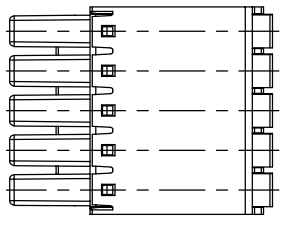
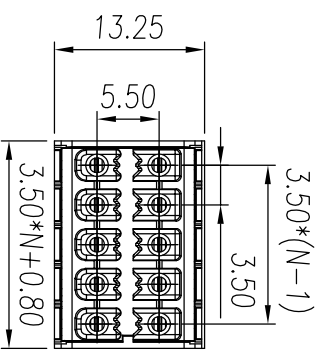

NOTES:

1. UL Standard

| Application | B | C | D |
|--------------------------|-----|---|-----|
| Rate voltage(V) | 300 | / | 300 |
| Rate current(A) | 8 | / | 8 |
| Rate impulse voltage(KV) | 1.6 | | |

Wire range : 26 ~ 16 AWG

2. IEC Standard

| Pollution degree | 2 | 2 | 3 |
|--------------------------|-----|-----|-----|
| Overvoltage category | II | III | III |
| Rate impulse voltage(KV) | 2.5 | 2.5 | 2.5 |
| Rate voltage(V) | 250 | 160 | 160 |
| Rate current(A) | 7 | | |

Wire range : 0.2 ~ 1.5 mm²

3. Pitch : 3.50 mm, Poles : N = 2*2 ~ 24*2 P

4. Stripping length : 8 ~ 10mm

5. Operating temperature: -40°C~+105°C

6. RoHS Compliance

7. Material: Housing PA66, UL94V-0

Clamp copper alloy, Sn plated

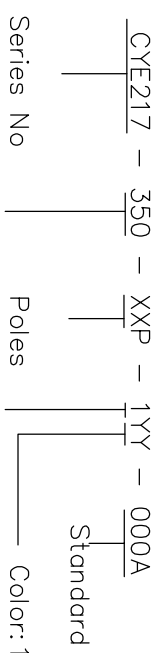

Pitch Single Pitch

- Color: 1Y, white
 2Y, black
 3Y, grey
 4Y, green
 5Y, blue
 6Y, yellow
 7Y, transparent
 8Y, brown

Remark: This drawing is a controlled document for Cymann. All specifications are subject to change without prior notice.

| linear dimension | ≡ | — | □ | // | ⊥ |
|------------------|----------------|-----------------|-----------------|--------------|----------------|
| over 18 to 30 | over 50 to 80 | over 120 to 160 | over 160 to 200 | all 5 to 30 | over 5 to 30 |
| over 30 to 50 | over 80 to 120 | over 160 to 200 | all 5 to 30 | over 5 to 30 | over 30 to 120 |
| tolerance ±0.15 | ±0.25 | ±0.35 | ±0.45 | ±0.60 | ±0.75 |
| | ±0.90 | 0.5 | 0.025 | 0.06 | 0.12 |
| | | | | | 0.4 |

| SIZE | SCALE | CHECKED | DATE | PART NO. |
|----------|-------|----------|------------|-------------------------|
| A4 | 3 : 2 | C. LU | 05/22/2021 | CYE217-350-XXP-1YY-000A |
| UNIT: mm | SHEET | APPROVED | DATE | CUSTOMER |
| 1 / 1 | 1 / 1 | H. JIANG | 05/22/2021 | Plug in connector |

Cymann 矽宇電子
 NINGBO CHANGYU ELECTRONICS MANUFACTURING CO., LTD
 Email: sales@cymann.com WWW.CYMANNU.COM