

REV	ECN	SIGN	DATE	DESCRIPTION
1.0	V0	K. ZHAO	05/30/2021	

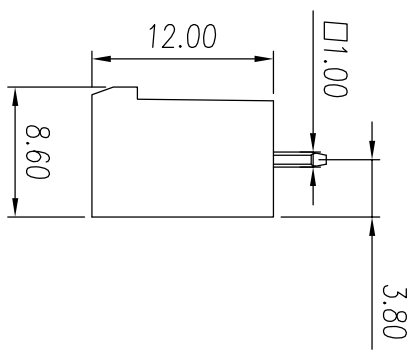
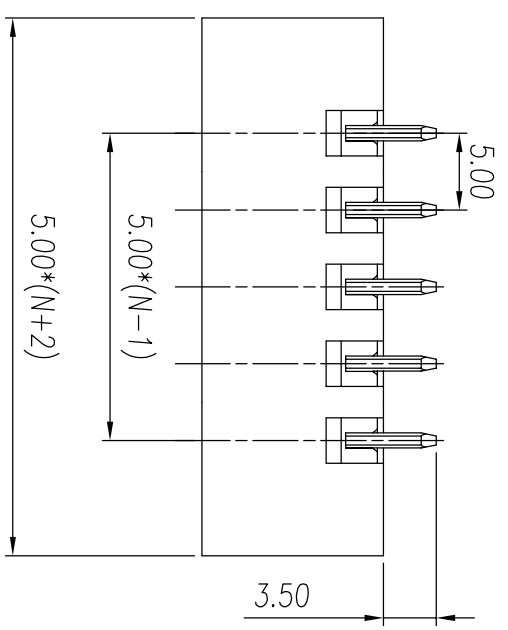
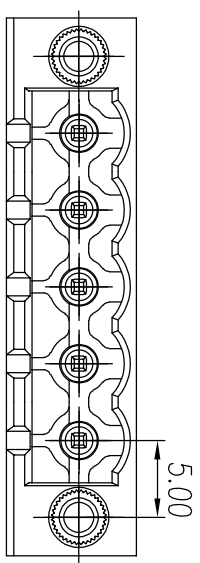
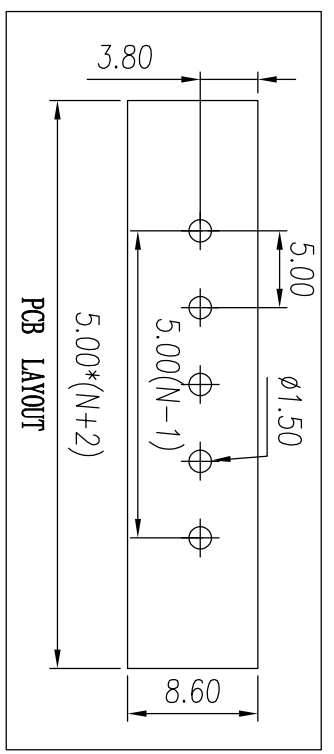

NOTES:  
1. UL Standard

Application	B	C	D
Rate voltage(V)	300	/	300
Rate current(A)	12	/	10
Rate impulse voltage(KV)	1.6		

2. IEC Standard

Pollution degree	2	2	3
Overvoltage category	II	III	III
Rate impulse voltage(KV)	4	4	4
Rate voltage(V)	320	320	250
Rate current(A)	15		

- 3. Pitch : 5.0 mm
- 4. Operating temperature: -40°C~+105°C
- 5. RoHS Compliance
- 6. Material: Housing PA66,UL94V-0
- Pin copper alloy, Sn plated
- Nut copper alloy

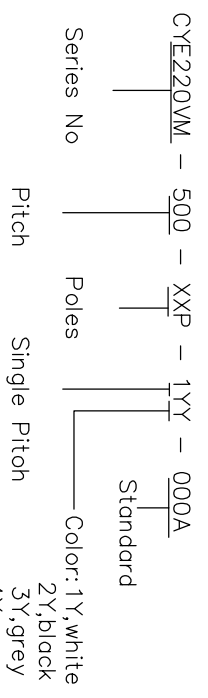

Remark: This drawing is a controlled document for Cymannu. All specifications are subject to change without prior notice.

		linear dimension										≡		□		//		⊥						
variable range	to	over	over	over	over	over	over	over	over	over	over	all	over	over	over	over	over	over	over					
tolerance	±0.15	±0.25	±0.35	±0.45	±0.60	±0.75	±0.90	0.5	0.025	0.06	0.12	0.4	10	18	30	50	80	120	160	200	5	5	30	120

SIZE: A4	SCALE: 2 : 1	DRAWN: K. ZHAO	CHECKED: C. LU	DATE: 05/30/2021
UNTT: mm	SHEET: 1 / 1	APPROVED: H. JIANG	DATE: 05/30/2021	

Part No: CYE220VM-500-XXP-1YY-000A  
Title: Plug in connector  
Customer:

**Cymannu** 矽宇電子  
NINGBO CHANGYU ELECTRONICS MANUFACTURING CO., LTD  
Email: sales@cymannu.com WWW.CYMANNU.COM